

# TX1061-7- UNIVERSITY OF QUEENSLAND STAFF HOUSE ROAD - STOP/GO w PEDESTRIAN MANAGEMENT

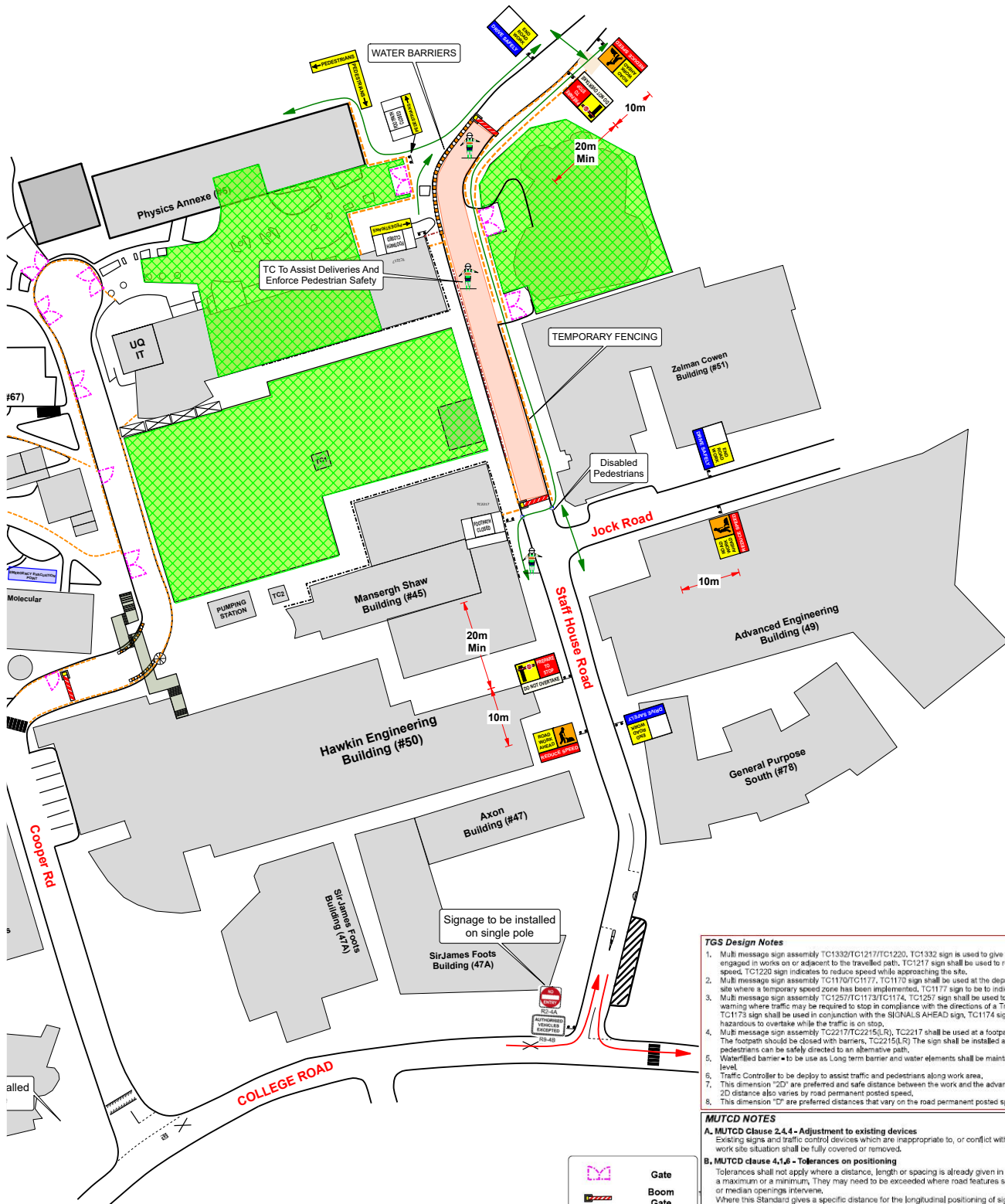

**Traffic Controller Notes:**

- TCs should occupy a position which is clear of the travel path.
- TC must have an escape path.
- TC must have sight distance of approaching traffic of at least 2D
- Enables effective communication to both site workers and other TC (if applicable).
- TC present to check/inspect temporary signage with regular intervals.
- TC should be standing at a safe distance away from work area.
- TC to assist local driveway access at all times.
- Traffic Control activities being performed on galleys roads shall be undertaken by experienced Traffic Control staff holding a QLD Government Industry Authority and/or TMC qualification (role specific qualifications).

	Gate
	Boom Gate
	Work Area
	Closed Lane
	Pedestrian Path
	Timber Hoarding
	Temporary Fencing
	Site Boundary

**TGS Design Notes**

- Multi message sign assembly TC1332/TC1217/TC1220, TC1332 sign is used to give warning of personnel engaged in works on or adjacent to the travelled path. TC1217 sign shall be used to return traffic to posted speed. TC1220 sign indicates to reduce speed while approaching the site.
- Multi message sign assembly TC1170/TC1177, TC1170 sign shall be used at the departure end of a work site where a temporary speed zone has been implemented. TC1177 sign to be used to indicate to drive safely.
- Multi message sign assembly TC1257/TC1173/TC1174, TC1257 sign shall be used to give advance warning where traffic may be required to stop in compliance with the directions of a Traffic Controller. TC1173 sign shall be used in conjunction with the SIGNALS AHEAD sign. TC1174 sign imposed that its hazardous to overtake while the traffic is on stop.
- Multi message sign assembly TC2217/TC2215(L/R), TC2217 shall be used at a footpath which is not in use. The footpath should be closed with barriers. TC2215(L/R) The sign shall be installed at a location where pedestrians can be safely directed to an alternative path.
- Waterfilled barrier to be used as Long term barrier and water elements shall be maintained at the required level.
- Traffic Controller to be deploy to assist traffic and pedestrians along work area.
- This dimension '2D' are preferred and safe distance between the work and the advance warning devices. 2D distance also varies by road permanent posted speed.
- This dimension 'D' are preferred distances that vary on the road permanent posted speed.

**MUTCD NOTES**

**A. MUTCD Clause 2.4.4 - Adjustment to existing devices**  
Existing signs and traffic control devices which are inappropriate to, or conflict with, the temporary work site situation shall be fully covered or removed.

**B. MUTCD Clause 4.7.6 - Tolerances on positioning**  
Tolerances shall not apply where a distance, length or spacing is already given in the text or a figure as a maximum or a minimum. They may need to be exceeded where road features such as intersections or median openings intervene.  
Where this Standard gives a specific distance for the longitudinal positioning of signs or devices with respect to other signs or features, for the spacing of delineating devices or for the length of tapers or markings, the following tolerances may be applied:  
(a) Positioning of signs, length of tapers or markings:  
(i) Minimum, 10% less than the distances or lengths given,  
(ii) Maximum, 25% more than the distances or lengths given.  
(b) Spacing of delineating devices:  
(i) Maximum, 10% more than the spacing shown,  
(ii) No minimum.

**C. MUTCD Clause 3.8 Table 3.7 Recommended Maximum spacing of cones & bollards**  
Recommended spacings of cones and bollards are given in Table 3.7. Spacing of cones and bollards may need to be reduced to as little as 1 m if needed to prevent traffic taking a wrong turn or wrong opening through a line of cones or bollards is placed.

**D. MUTCD Clause 4.10.6 - Period of Duty**  
Traffic controllers shall be relieved from their duty after not more than 2 hours for a period of rest or 'other duties' of at least 15 minutes. ['Other duties' does not include operation of a STCP/SLOW bat to control traffic or any duties involving standing in one position, or controlling traffic with a traffic control device].



**SITE SPECIFICS**

Client: HANSEN YUNKEN  
 Ordered By: TERRY WELCH  
 Phone: 0438 168 104  
 Site Contact: AS ABOVE  
 Phone: AS ABOVE  
 Work Activity: DELIVERY WORKS

Job Location: STAFF HOUSE ROAD  
 Cross Sts: OLD COOPER RD - COLLEGE RD  
 Suburb: SAINT LUCA, 4067  
 Road/Built up: BUILT UP  
 Road Configuration: TWO WAY  
 Example Diagram: 4/11  
 Traffic Method: STOP AND GO/FOOTPATH CLOSURE

Local Council: BRISBANE CITY C.  
 ID/TMR District: METROPOLITAN  
 OPS District: METRO SOUTH  
 Risk Assessment: DES/STOP  
 Posted Speed: 30  
 Speed Reduction: -  
 Onsite Communication: UHF (Channel TBC)

Order No: N/A  
 Start Date: TBA  
 Proposed Duration: 1+2 SHIFTS  
 Long/Short Term: SHORT TERM  
 Static/Mobile: STATIC  
 Worker to Traffic: <1.2m  
 Working Hours: Per permit or similar



TX1061-7A				(SHEET 1 OF 1)			
NO.	DESCRIPTION	DATE	DESIGNED BY	TMD	SIGNATURE	APPROVED BY	TMD
01	INITIAL DESIGN	04.11.2020	Adnan Durran			Muhammad Tariq	200 (OPEN)
02	AMENDMENT	09.11.2020	Adnan Durran			Muhammad Tariq	200 (OPEN)